

Product Features

- Line and Panel mounting pressure regulator
- Brass chrome plated body for non-corrosive gases and mixtures up to grade 6.0
- Stainless steel 316L body for corrosive gases
- 4 ports flexible configuration
- Stable outlet pressure
- Simple outlet pressure limitation by handwheel
- Inlet filter
- Tested for use with oxygen

Typical Applications

- Component Testing
- Calibration Systems
- Laboratory Pressure Control
- High Pressure Sampling Systems
- Service & Test Equipment

Dimensions (mm)

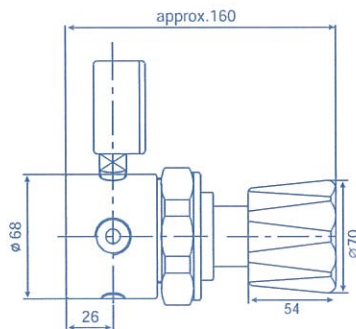

VSR-3L & VSR-3P Series

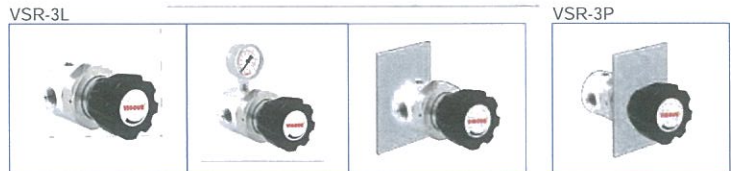

Technical Data

Type:	single-stage
Inlet pressure P ₁ :	max. 100bar
Outlet pressure P ₂ :	2/4/10/20/ 35/50bar
Materials	
Body regulator	see ordering info
Valve seat:	PCTFE
Diaphragm:	Hastelloy® C276
O-ring: (option)	Viton® (FKM) Kalrez® (FFKM)
Filter:	SS 316L
Inlets and Outlets:	see ordering info
Temperature range:	-30°C to +74°C
Leak rate (to atmosphere) (via seat)	1x10 ⁻⁸ mbar l/s He 1x10 ⁻⁶ mbar l/s He
Flow capacity:	C _v =1.7
Weight:	2.8 kg

Flow Chart

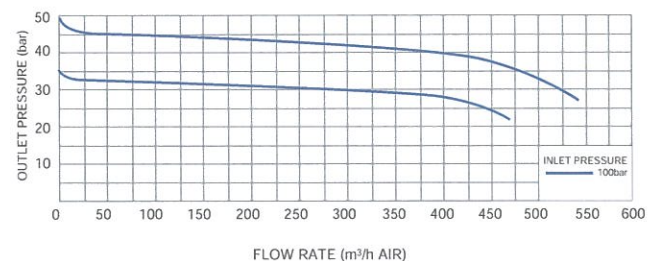
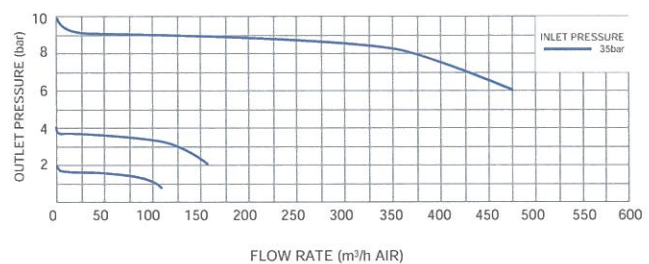

Wir bieten Lösungen für Ihre Ideen!
We offer solutions regarding your ideas!

Ordering Information

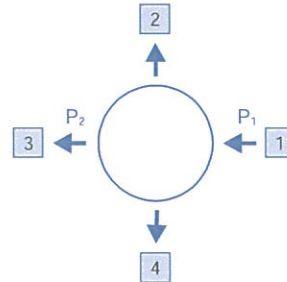

Inlets / Outlets

- | | |
|--------------------|--------------------|
| 00: 1/4"NPT(F) | 68: 20mm Weld tube |
| 02: 3/8"NPT(F) | P: Gauge(Psig/bar) |
| 04: 1/2"NPT(F) | B: Plug |
| 06: 3/4"NPT(F) | |
| 67: 12mm Weld tube | |

* Other connection standard, consult factory.

Port Selection

VSR - 3P S - 100 - 20 - 1 - 2 - 3 - 4 - N2

Type

- L: Line
- P: Panel

Body Material

- S: 316L
- C: Chrome Plated Brass
- B: Brass

Inlet Pressure P₁

- 40: 40 bar
- 100: 100 bar

Outlet Pressure P₂

- 2: to 2 bar
- 4: to 4 bar
- 10: to 10 bar
- 20: to 20 bar
- 35: to 35 bar
- 50: to 50 bar

Type of Gas

Please specify type of gas

Ordering Example

Example: VSR - 3L S - 100 - 4 - 04 - P - 04 - B - O₂

